

Drilling and cutting





MANNESMANN DEMAG drilling and cutting tools are distinguished by:

- Ergonomic design
- Low air consumption
- Very low noise levels
- Absolutely easy to service and uncomplicated to maintain
- Modular systems: various assemblies are interchangeable
- Conception for precise as well as for rugged industrial applications



Drills

Our wide range – drilling from 1 to 50 mm, with straight, angled or pistol grip designs – guarantees suitable drilling in all applications. The choice of the right drill is determined firstly by the drilling diameter, the material and the cutting speed which is required.

Countersinks

Our countersinks offer a perfect program for all deburring works, which must be accomplished by hand. The countersinks are ideal tools to deburr, spot face or chamfer steel, cast iron, non-ferrous or light metals. The low and variable cutting speed ensures best working results.

Tapping machines

MANNESMANN DEMAG tapping machines are in the best way suitable for cutting and cleaning threads. Grace to the optimized power-weight ratio and the handy design the tools offer opportunities for all kind of manufacturing applications. Our tapping tools are equipped with a two jaw pendular chuck with a round wedge.

→ Simply work more rational – with MANNESMANN DEMAG drills, countersinks and tapping machines.

Drills (pistol grip)

With gear rim drill chuck

- Exhaust silencer is built into the pistol grip so that there is no disruptive exhaust air
- Compact design
- Ergonomical aluminium handle
- Low maintenance
- Air supply through handle
- D 6-55 P also suitable for sinking



1

2

Technical data

| Type | | D 6-501 P | D 6-351 P | D 6-55 P | D 8-6000 P | D 8-2800 P |
|---------------------------|-------------------|--------------------|--------------------|--------------------|--------------------|--------------------|
| Order No. | | 03138-77-4 | 03138-97-4 | 03255-00-5 | 29919-70-5 | 46910-46-5 |
| Illustration | | 1 | 1 | 1 | 2 | 2 |
| Free speed | min ⁻¹ | 5 000 | 3 500 | 550 | 6 000 | 2 800 |
| Power | Watt | 150 | 150 | 150 | 320 | 320 |
| DIN taper | | B 10 | B 10 | B 10 | B 12 | B 12 |
| Drill chuck clamp. range | mm | 1 – 6 | 1 – 6 | 1 – 6 | 1 – 8 | 1 – 8 |
| Drilling capacity steel | mm | 4 | 4 | 4 | 6 | 6 |
| Drilling capacity alumin. | mm | 6 | 6 | 6 | 10 | 10 |
| Noise level | dB(A) | 69 | 69 | 69 | 75 | 75 |
| Air consumption | l/sec | 5.3 | 5.3 | 5.3 | 7.0 | 7.0 |
| Weight without hose | kg | 0.60 | 0.60 | 0.65 | 1.00 | 1.00 |
| ∅ machine | mm | 31 | 31 | 31 | 38 | 38 |
| Machine length | mm | 162 | 162 | 188 | 195 | 198 |
| Hose I.D. | mm | 6 | 6 | 6 | 6 | 6 |
| Connection | | G 1/4" i | G 1/4" i | G 1/4" i | G 1/4" i | G 1/4" i |
| Accessories supplied | | drill chuck key | drill chuck key | drill chuck key | drill chuck key | drill chuck key |

Power and free speed at 6 bar operating pressure. Compressed air quality: oiled.

Accessories



| For type | D 6-501 P | D 6-351 P | D 6-55 P | D 8-6000 P | D 8-2800 P |
|---------------------------------|-----------|-----------|-----------|------------|------------|
| Gear rim drill chuck | 9 376 019 | 9 376 019 | 9 376 019 | 9 376 014 | 9 376 014 |
| Drill chuck key | 9 369 811 | 9 369 811 | 9 369 811 | 9 369 811 | 9 369 811 |
| Quick change drill chuck | 9 369 990 | 9 369 990 | 9 369 990 | 9 369 988 | 9 369 988 |

- Exhaust silencer is built into the pistol grip so that there is no disruptive exhaust air
- Compact design
- Ergonomical aluminium handle
- Low maintenance
- Air supply through handle
- D 13-45 P with quick change drill chuck

Drills (pistol grip) With gear rim drill chuck



1



2



3

Technical data

| Type | | D 10-1800 P | D 13-900 P | D 13-380 P | D 13-45 P | D 15-600 P | D 15-1800 P |
|---------------------------|-------------------|-----------------|-----------------|-----------------|---------------|-------------------------------|-------------------------------|
| Order No. | | 46920-36-5 | 46920-37-5 | 46920-39-5 | 29900-01-6 | 47470-53-5 | 47420-53-5 |
| Illustration | | 1 | 1 | 1 | 2 | 3 | 3 |
| Free speed | min ⁻¹ | 1 500 | 900 | 380 | 450 | 600 | 1 800 |
| Power | Watt | 320 | 320 | 300 | 400 | 520 | 520 |
| DIN taper | | B 12 | B 12 | B 12 | 1/2" × 20 UNF | 3/8" × 24 UNF | 3/8" × 24 UNF |
| Drill chuck clamp. range | mm | 1 – 10 | 1 – 13 | 1 – 13 | 1,5 – 13 | 3 – 13 | 3 – 13 |
| Drilling capacity steel | mm | 8 | 8 | 8 | 13 | 13 | 8 |
| Drilling capacity alumin. | mm | 12 | 12 | 12 | 20 | 20 | 12 |
| Noise level | dB(A) | 75 | 75 | 75 | 79 | 77 | 77 |
| Air consumption | l/sec | 7.0 | 7.0 | 7.0 | 9.0 | 11.3 | 11.3 |
| Weight without hose | kg | 1.10 | 1.25 | 1.30 | 1.90 | 2.40 | 1.25 |
| Ø machine | mm | 38 | 38 | 38 | 45 | 54 | 54 |
| Machine length | mm | 232 | 234 | 240 | 260 | 247 | 226 |
| Hose l. D. | mm | 8 | 8 | 10 | 10 | 10 | 10 |
| Connection | | G 1/4" i | G 1/4" i | G 1/4" i | G 1/4" i | G 1/4" i | G 1/4" i |
| Accessories supplied | | drill chuck key | drill chuck key | drill chuck key | side handles | drill chuck key, side handles | drill chuck key, side handles |

Power and free speed at 6 bar operating pressure. Compressed air quality: oiled.

Accessories



| For type | D 10-1800 P | D 13-900 P | D 13-380 P | D 13-45 P | D 15-600 P | D 15-1800 P |
|---------------------------------|-------------|------------|------------|------------|------------|-------------|
| Gear rim drill chuck | 9 376 014 | 9 376 017 | 9 376 017 | — | 9 369 821 | 9 369 821 |
| Drill chuck key | 9 369 811 | 9 376 018 | 9 376 018 | — | 9 376 018 | 9 376 018 |
| Quick change drill chuck | 9 369 989 | 9 369 991 | 9 369 991 | 9 369 992 | — | — |
| Side handles | — | — | — | 29943-42-6 | 47409-00-5 | 47409-00-5 |

Drills (straight)

With gear rim drill chuck

- Suitable for vertical drilling work
- Exhaust air to the rear
- Very low-noise
- DS-model with collet suitable for brushing
- Handy and light-weight



1

Technical data

| Type | | D 6-5000 H | D 6-3500 H | D 8-6002 H | D 8-3702 H | D 8-2802 H |
|---------------------------|-------------------|-----------------|-----------------|----------------------------|----------------------------|----------------------------|
| Order No. | | 48100-30-5 | 48100-31-5 | 29945-33-5 | 29945-34-5 | 29945-35-5 |
| Illustration | | 1 | 1 | 1 | 1 | 1 |
| Valve | | lever valve | lever valve | lever valve | lever valve | lever valve |
| Free speed | min ⁻¹ | 6 000 | 3 500 | 6 000 | 3 700 | 2 800 |
| Power | Watt | 150 | 150 | 320 | 320 | 320 |
| DIN taper | | B 10 | B 10 | B 12 | B 12 | B 12 |
| Drill chuck clamp. range | mm | 1 – 6 | 1 – 6 | 1 – 8 | 1 – 8 | 1 – 8 |
| Drilling capacity steel | mm | 4 | 5 | 6 | 6 | 6 |
| Drilling capacity alumin. | mm | 6 | 8 | 10 | 10 | 10 |
| Noise level | dB(A) | 67 | 67 | 70 | 70 | 70 |
| Air consumption | l / sec | 4.2 | 4.2 | 5.3 | 5.3 | 5.3 |
| Weight without hose | kg | 0.70 | 0.70 | 1.20 | 1.20 | 1.20 |
| Ø machine | mm | 31 | 31 | 38 | 38 | 38 |
| Machine length | mm | 195 | 195 | 222 | 222 | 226 |
| Hose l. D. | mm | 6 | 6 | 6 | 6 | 6 |
| Connection | | G 1/4" i | G 1/4" i | G 1/4" i | G 1/4" i | G 1/4" i |
| Accessories supplied | | drill chuck key | drill chuck key | drill chuck key, hose unit | drill chuck key, hose unit | drill chuck key, hose unit |

Power and free speed at 6 bar operating pressure. Compressed air quality: oiled.

Accessories



| For type | D 6-5000 H | D 6-3500 H | D 8-6002 H | D 8-3702 H | D 8-2802 H |
|---------------------------------|------------|------------|------------|------------|------------|
| Gear rim drill chuck | 9 376 019 | 9 376 019 | 9 376 014 | 9 376 014 | 9 376 014 |
| Drill chuck key | 9 369 811 | 9 369 811 | 9 369 811 | 9 369 811 | 9 369 811 |
| Quick change drill chuck | 9 369 990 | 9 369 990 | 9 369 988 | 9 369 988 | 9 369 988 |
| Hose unit | 29200-31-5 | 29200-31-5 | 29923-33-5 | 29923-33-5 | 29923-33-5 |

Hose unit incl. supply air and exhaust air hose.

- Suitable for vertical drilling work
- Exhaust air to the rear
- Very low-noise
- DS-model with collet suitable for brushing
- Handy and light-weight

Drills (straight) With collet



Technical data

| Type | | DS 6000-100 H | DS 6002 H | DS 6-5000 H | DS 8-2802 H |
|----------------------|-------------------|---------------------------|---------------------------|----------------|---------------------------|
| Order No. | | 60016-00-5 | 29945-99-5 | 48100-20-5 | 29945-36-5 |
| Illustration | | 1 | 3 | 2 | 3 |
| Valve | | lever valve | lever valve | lever valve | lever valve |
| Free speed | min ⁻¹ | 6 000 | 6 000 | 5 000 | 2 800 |
| Power | Watt | 320 | 320 | 150 | 320 |
| Collet included | mm | 6 | 6 | 6 | 8 |
| Noise level | dB(A) | 70 | 70 | 67 | 70 |
| Air consumption | l/sec | 5.3 | 5.3 | 4.2 | 5.3 |
| Weight without hose | kg | 1.30 | 1.00 | 0.70 | 1.10 |
| ∅ machine | mm | 38 | 38 | 31 | 38 |
| Machine length | mm | 311 | 197 | 180 | 197 |
| Hose I. D. | mm | 6 | 6 | 6 | 6 |
| Connection | | G 1/4" i | G 1/4" i | G 1/4" i | G 1/4" i |
| Accessories supplied | | Collet, wrench, hose unit | Collet, wrench, hose unit | Collet, wrench | Collet, wrench, hose unit |

Power and free speed at 6 bar operating pressure. Compressed air quality: oiled.

Accessories



| For type | DS 6000-100 H | DS 6002 H | DS 6-5000 H | DS 8-2802 H |
|--------------------|---------------|------------|-------------|-------------|
| Collet 6 mm | 9 369 826 | 9 369 826 | 9 369 918 | 9 369 826 |
| Collet 8 mm | 9 369 843 | 9 369 843 | — | 9 369 843 |
| Hose unit | 29923-33-5 | 29923-33-5 | 29200-31-5 | 29923-33-5 |

Hose unit incl. supply air and exhaust air hose.

Drills

With Morse taper

- For rugged industrial applications
- Drill bits are changed by means of a feeding spindle
- Long handles mean that only a small supporting force is required



D 1601



D 2500

Technical data

| Type | | D 1601 | D 2500 |
|--|----------------------|------------|------------|
| Order No. | | 41600-01-6 | 42500-00-6 |
| Direction of rotation | | clockwise | reversible |
| Drilling in steel up to | mm | 19 | 32 |
| Reaming up to | mm | — | 26 |
| Tapping up to | mm | — | 26 |
| Rolling on of pipes up to | mm | — | 25 |
| Morse taper | | 2 | 3 |
| Free speed | rpm | 650 | 300 |
| Air consumption | m ³ / min | 1.3 | 1.9 |
| Power | kW | 1.1 | 1.8 |
| Spindle feeding range max. | mm | 70 | 80 |
| Distance between spindle centre and housing outside edge | mm | 30 | 34 |
| Length | mm | 255 | 313 |
| Weight | kg | 7.0 | 15.0 |
| Hose I. D. | mm | 12 | 15 |
| Connection | | G 3/8" i | G 3/4" i |

Power and free speed at 6 bar operating pressure. Compressed air quality: oiled.



Accessories supplied

| For type | D 1601 | D 2500 |
|--------------------------|-----------|-----------|
| External thread coupling | 9 361 337 | 9 361 339 |

- The speed regulator fitted as standard ensures that a constant speed can be maintained, even under the smallest load
- This means that there is very little wear on the vanes
- Drill bits are changed by means of a feed screw
- The very small centre-to-centre distance allows the drills to be used close to walls

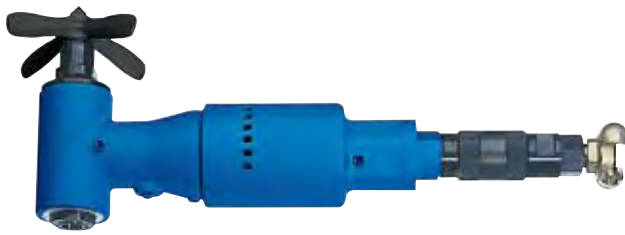

D 3350



D 3400

Clockwise | Technical data

| Type | | D 3300 | D 3350 | D 3400 | D 3450 |
|---|---------------------|------------|------------|------------|------------|
| Order No. | | 43300-00-6 | 43350-00-6 | 43400-00-6 | 43450-00-6 |
| Direction of rotation | | clockwise | clockwise | clockwise | clockwise |
| Drilling in steel up to | mm | 15 | 23 | 32 | 50 |
| Reaming up to | mm | 12 | 18 | 27 | 36 |
| Morse taper | | 1 | 2 | 3 | 4 |
| Free speed | min ⁻¹ | 500 | 280 | 280 | 220 |
| Air consumption, under load | m ³ /min | 0.6 | 1.6 | 2.1 | 2.2 |
| Air consumption, at free speed | m ³ /min | 0.6 | 0.7 | 0.8 | 1.0 |
| Power | kW | 0.48 | 1.50 | 2.10 | 2.20 |
| Length | mm | 318 | 446 | 480 | 507 |
| Height | mm | 141 | 193 | 215 | 239 |
| Feed via feed screw | mm | 45 | 60 | 75 | 75 |
| Distance from centre of spindle to outer edge | mm | 25 | 30 | 35 | 40 |
| Weight | kg | 2.9 | 8.3 | 11.7 | 13.9 |
| Hose I. D. | mm | 10 | 15 | 15 | 19 |
| Connection | | G 3/8" i | G 1/2" i | G 1/2" i | G 1/2" i |

Power and free speed at 6 bar operating pressure.



Accessories supplied

| For type | D 3300 | D 3350 | D 3400 | D 3450 |
|--------------------------|-----------|-----------|-----------|-----------|
| External thread coupling | 9 361 337 | 9 361 338 | 9 361 337 | 9 361 338 |

Angle drills

With gear rim drill chuck, collet

- Angle drills with collet for difficult to access areas
- Quick-action drill chuck on request
- Lever start
- Exhaust air to the rear



DW 2200



DWS 2201



DW 700

Technical data

| Type | | DW 2200 | DWS 2200 | DW 700 |
|----------------------------|-------------------|-----------------|----------------|-----------------|
| Order No. | | 29945-65-6 | 29945-67-6 | 29945-66-6 |
| Valve | | lever valve | lever valve | lever valve |
| Free speed | min ⁻¹ | 2 200 | 2 200 | 700 |
| Power | Watt | 300 | 300 | 300 |
| Collet | mm | — | 6 | — |
| Drill chuck clamping range | mm | 1 – 8 | — | 1 – 10 |
| Taper DIN | | 3/8" × 24 UNF | — | 3/8" × 24 UNF |
| Noise level | dB(A) | 76 | 76 | 76 |
| Air consumption | l/sec | 9 | 9 | 9 |
| Length | mm | 255 | 255 | 285 |
| Head height | mm | 83 | 54 | 90 |
| Ø machine | mm | 40 | 40 | 40 |
| Weight | kg | 1.10 | 1.00 | 1.30 |
| Connection | G | 1/4" i | 1/4" i | 1/4" i |
| Hose I.D. | mm | 8 | 8 | 8 |
| Accessories supplied | | drill chuck key | wrench, collet | drill chuck key |

Power and free speed at 6 bar operating pressure. Compressed air quality: oiled.

Accessories



| Gear rim drill chuck | DW 2200 | DWS 2200 | DW 700 |
|----------------------|-----------|-----------|-----------|
| Order No. | 9 376 023 | — | 9 376 022 |
| Collets | | | |
| 3 mm | — | 9 369 855 | — |
| 5 mm 3/16" | — | 9 369 850 | — |
| 6 mm | — | 9 369 839 | — |

Collets
1 | 1,5 | 3,5 | 4,5 | 5,5 mm
available on request.

Countersinks

Deburring of drillings

- Extremely quiet and robust
- Push start as soon as pressure is applied (Type BS 502)
- Low air consumption, as drive is only active during actual operation
- Thus leading to longer service life
- Suitable for additional activities during the main production time on CNC machine tools
- Cold-insulating handle
- The ergonomic design of the handle means that work is non-tiring
- BS 502, BSW 903 and BSW 506 with speed regulator
- The ease of operation is supported by a starter button on the type BS 500 P
- BSW 903 and BSW 506 (angle version) for deburring of difficult to access areas, e.g. holes with cross sections



BS 502

BS 500 P

Technical data

| Type | | BS 502 | BS 500 P | BSW 903 | BSW 506 |
|---------------------------------|-------|-----------------|-----------------|-------------|-------------|
| Order No. | | 29602-46-5 | 29500-32-5 | 60012-08-5 | 29945-64-5 |
| Valve | | thrust start | starter button | lever valve | lever valve |
| Free speed | rpm | 500 | 500 | 900 | 500 |
| Speed regulator | | ja | nein | ja | ja |
| Power | Watt | 160 | 160 | 35 | 65 |
| Sinking range | mm | 5 – 30 | 5 – 30 | 2 – 10 | 5 – 25 |
| Collet included | mm | 8 | 8 | 3 skt | 1/4" skt |
| Collet available | mm | 6, 10 | 6, 10 | — | — |
| Noise level | dB(A) | 65 | 63 | 68 | 71 |
| Air consumption | l/sec | 5.0 | 5.0 | 2.8 | 5.0 |
| Weight without hose | kg | 0.65 | 0.78 | 0.40 | 0.85 |
| Ø machine | mm | 31 | 31 | 25 | 30 |
| Machine length | mm | 230 | 190 | 258 | 295 |
| Head height without counterbore | mm | — | — | 18 | 30.5 |
| Hose unit | | | | | |
| Supply air hose | m | 1.5 | — | 1.5 | 1.5 |
| Exhaust air hose | m | 1 | — | 1 | 1 |
| Connection | | G 1/4" | G 1/4" i | G 1/4" | G 1/4" |
| Accessories supplied | | drill chuck key | drill chuck key | — | — |

Power and free speed at 6 bar operating pressure. Compressed air quality: oiled.



BSW 903

BSW 506

Countersinks

Deburring of drillings



HSS counterbore BS



HSS counterbore BSW 506



HSS counterbore BSW 903

HSS counterbores

For types BS 502 and BS 500 P

3 teeth, shaft 8 Ø / 90°

| | |
|---------------------------|------------|
| Sinking range 3.5 – 14 mm | 48109-11-6 |
| Sinking range 5 – 25 mm | 48109-10-6 |
| Sinking range 5 – 30 mm | 48109-09-6 |

For type BSW 506

3 teeth, 1/4" hexagon / 90°

| | |
|-----------------------------|------------|
| Sinking range 2.5 – 10 mm | 48109-21-6 |
| Sinking range 3.2 – 16,5 mm | 48109-22-6 |
| Sinking range 3.5 – 20.5 mm | 48109-23-6 |
| Sinking range 5 – 25 mm | 48109-24-6 |

For type BSW 903

3 teeth, 3 mm hexagon / 90°

| | |
|-------------------------|------------|
| Sinking range 2 – 6 mm | 48109-26-6 |
| Sinking range 2 – 10 mm | 48109-25-6 |

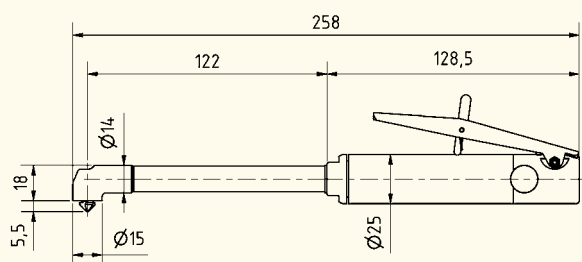

BSW 903

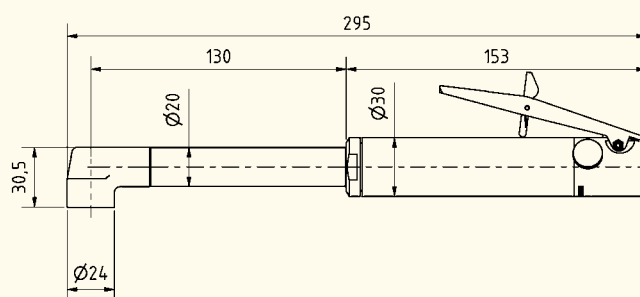

BSW 506

Accessories

| Hose unit | BS 502 | BS 500 P | BSW 903 | BSW 506 |
|-----------|------------|-----------|------------|------------|
| Order No. | 29603-25-5 | — | 60012-24-5 | 29603-25-5 |
| Collets | | | | |
| 6 mm | 9 369 837 | 9 369 837 | — | — |
| 8 mm | 9 369 818 | 9 369 818 | — | — |
| 10 mm | 9 369 817 | 9 369 817 | — | — |

- Handy-ergonomic aluminium handle
- Quiet, high power
- Reversible forward and return speed with rocker
- Efficient operation: pendular chuck makes it easy to start the cut
- Optimum cutting power
- Double reverse speed at model G 14-6P
- Model G 14-6 P: reversing pull-pull gear
- With quick change chuck upon request



GE 8-500 P



G 14-6 P

| Type | | GE 8-500 P | GE 8-900 P | G 14-6 P |
|-----------------------|-------|----------------|----------------|--------------------------|
| Order No. | | 47060-06-5 | 47060-08-5 | 47650-53-5 |
| Free speed | rpm | 500 | 900 | 600 |
| Power | Watt | 200 | 200 | 550 |
| Pendular chuck | | yes | yes | yes |
| Square clamping range | mm | 3 – 9 | 3 – 9 | 3 – 9 |
| Taper DIN 238 | | B 12 | B 12 | B 12 |
| Tapping in steel | mm | M 6 | M 6 | M 14 |
| Tapping in aluminium | mm | M 8 | M 8 | M 16 |
| Ø machine | mm | 38 | 38 | 52 |
| Machine length | mm | 251 | 251 | 318 |
| Noise level | dB(A) | 77 | 77 | 78 |
| Weight without hose | kg | 1.20 | 1.20 | 2.20 |
| Air consumption | l/sec | 4.5 | 4.5 | 9.0 |
| Hose I.D. | mm | 6 | 6 | 10 |
| Connection | | G 1/4" i | G 1/4" i | G 1/4" i |
| Accessories supplied | | pendular chuck | pendular chuck | pend. chuck, side handle |

Power and free speed at 6 bar operating pressure. Compressed air quality: oiled.

Accessories

| Type | Tapping chuck assy. | Drill chuck key | Integral chuck jaws | Side handles |
|--------------------------|---------------------|-----------------|---------------------|--------------|
| GE 8 without round wedge | 9 369 982 | 9 369 834 | 9 369 954 | 03256-00-5 |
| G 14 with round wedge | 9 369 833 | 9 369 834 | 9 369 955 | 03208-97-6 |



Swivel joint

Variacor 60001-60-6

Further Information see p. 164

Tapping tools

Straight version

- Safety lever
- Non-lubrication use possible
- Noise dampening system
- Ergonomic design
- Multi-functional

 **Direction change:**
All models change tapping direction
by push - pull



MAS 8

Technical data

| Type | | MAS 8 | MAY 10 | MAY 12 |
|-----------------------------|-------------------|--|-------------|-------------|
| Order No. | | 134 610 108 | 136 309 028 | 136 309 016 |
| Clockwise running upon push | | Lever start | Lever start | Lever start |
| Free speed clockwise | min ⁻¹ | 500 | 450 | 220 |
| Free speed counterclockwise | min ⁻¹ | 800 | 930 | 470 |
| Quick change chuck | | yes | yes | yes |
| Tapping in steel | mm | M 8 | M 10 | M 12 |
| Tapping in aluminium | mm | M 12 | M 13 | M 14 |
| Noise level | dB(A) | 74 | 78 | 78 |
| Air consumption | l/sec | 9 | 11 | 11 |
| Machine length | mm | 240 | 335 | 335 |
| Ø machine | mm | 40 | 46 | 46 |
| Weight without hose | kg | 0.98 | 1.82 | 1.82 |
| Connection | G | 1/4" i | 1/4" i | 1/4" i |
| Hose I.D. | mm | 8 | 8 | 8 |
| Accessories supplied | | quick change chuck for tap holders, side handle, support | | |

Power and free speed at 6 bar operating pressure. Compressed air quality: oiled.

- Tap holders ensure a quick working when different taps are needed



Quick change chuck

Quick change chuck for standard tap holders

| For tapping machines | Order No. |
|----------------------|-------------|
| MAS 8 | 65 941 1001 |
| MAY 10 | 65 961 1001 |
| MAY 12 | 65 961 1001 |



Tap holders

Tap holders

| | ∅ Shaft (tap) mm | □ Drive square (tap) | Order No. |
|-------------|------------------|----------------------|-------------|
| M 2 | 2,8 | 2,1 | 65 521 1028 |
| M 3 | 3,5 | 2,7 | 65 527 1035 |
| M 3,5 | 4,0 | 3,0 | 65 530 1040 |
| M 4 | 4,5 | 3,4 | 65 534 1045 |
| M 5 6 8 | 6,0 | 4,9 | 65 549 1060 |
| M 10 | 7,0 | 5,5 | 65 555 1070 |
| M 11 | 8,0 | 6,2 | 65 562 1080 |
| M 12 | 9,0 | 7,0 | 65 570 1090 |
| M 14 | 11,0 | 9,0 | 65 590 1110 |

Air saw

For sheet steel, aluminium and plastics



SRV 110

- The air saw is ideal for the processing of sheet steel (carbody sheet, pipes made of sheet metal etc.), aluminium and plastics
- High cutting speed
- High performance at low air consumption
- Low noise level
- Patented anti vibration system
- Steel saw blades
- Safety lever according to EN 792
- Fullfills the European Union guideline 2002 / 44 / EC with the vibration value of 2 m / s²

Technical data

| Type | | SRV 110 |
|----------------------|---------|-------------------------------|
| Order No. | | 29800-27-6 |
| Number of blows | rpm | 9 000 |
| Stroke length | mm | 8 |
| Air consumption | l / sec | 1.5 |
| Noise level | dB(A) | 80 |
| Ø machine | mm | 41 |
| Machine length | mm | 210 |
| Weight without hose | kg | 1.15 |
| Hose I. D. | mm | 8 |
| Connection | | G 1/4" |
| Accessories supplied | | wrench, 1 set of saw blade |

Power and free speed at 6 bar operating pressure. Compressed air quality: oiled.



Saw blades | length 96 mm

| Range of application | Tooth distance | Teeth per inch | Order No. |
|---|----------------|----------------|------------|
| ST 37 / V2A and non-ferrous metals up to 1 mm. Suitable for curved cut. | 0.8 mm | 32 | 29905-10-6 |
| ST 37 / V2A and non-ferrous metals up to 2 mm. Suitable for curved cut. | 1.0 mm | 24 | 29905-11-6 |
| ST 37 / V2A and non-ferrous metals up to 2.5 mm. Wood, plastics, laminated fabrics. | 1.8 mm | 14 | 29905-12-6 |